

# TRITON Floating Mantel Kit

## FMK-WH-TR50

### Model: SF-TR50

- Instructions -

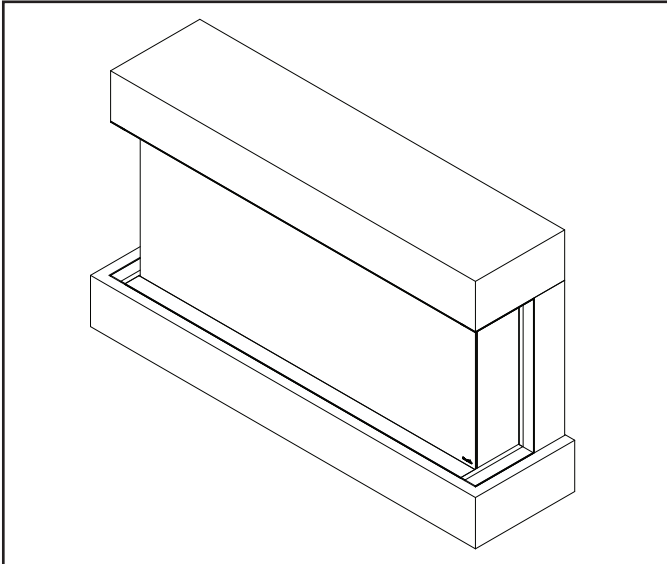

Leave this manual with party responsible for use and operation.

**NOTICE! DO NOT discard this manual.** Important service and maintenance instructions included.

The Floating Mantel is painted in white finish. For instructions on refinishing a surround, see page 2. It is recommended that refinishing be completed prior to installation of surround.

## Tools and Supplies Needed

Before beginning the installation be sure that the following tools and building supplies are available.

- Tape measure
- Needle-nose pliers
- Hammer
- Gloves
- Level
- Magnetic Phillips screwdriver
- Safety glasses
- Flat blade screwdriver
- 1/2 in. drill bit for 3/16 diameter toggle bolts (applicable if installing on masonry walls)
- Masonry drill bit 5/16 in. (applicable if installing on masonry walls)

## Kit Components

- Mantel Bottom
- Mantel Top
- Mantel Side Panel (2)
- Side Bracket (2)
- Side Bottom Brackets (2)
- Top Side Trim Brackets (2)
- Front Bracket (1)
- ST4\*12 Screws (13)
- ST6\*50 Screws (11)
- M5\*10 Screws (2)
- M6\*16 Screws (8)
- 6\*30 Wooden Dowels (8)
- Masonry Anchors (11)
- Wall Mount Bracket (1)
- Toggle Bolt Anchors (11)
- Plug-in Power Cord (1)
- Stabilizing Bracket (1)

### INCLUDED WITH MANTEL KIT

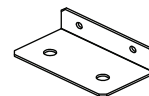

SIDE BRACKETS (2)

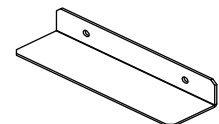

SIDE BOTTOM BRACKETS (2)

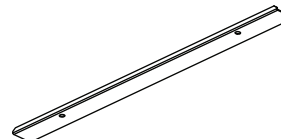

FRONT BOTTOM BRACKET (1)

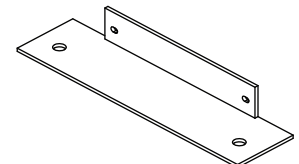

TOP SIDE TRIM BRACKETS (2)

### WITH APPLIANCE

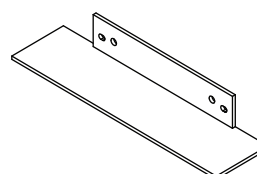

BOTTOM SIDE TRIM BRACKETS (2)

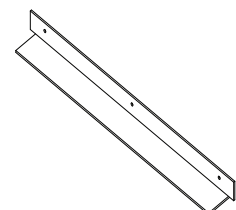

BACK SIDE TRIM BRACKETS (2)  
(OPTIONAL)

Figure 1 Bracket

**NOTICE:** The total weight of objects placed on the mantel shelf must not exceed 100 lbs (45 Kg).

Refer to the appliance installation instructions to prepare the appliance for the appropriate electrical wiring configuration. If using the available plug-in wiring kit, there is a cutout located on the bottom piece to fit the cord.

**Refinishing Process**

- 1. Cover any areas of the workspace that will not be painted.
- 2. Lightly scuff the existing finish with 320 grit sandpaper.
- 3. Remove the dust created by the sanding process using a lint free cloth.
- 4. For best results, apply a base coat of spray paint primer to evenly cover the surround.
- 5. Wait the recommended drying time as indicated in the paint and primer instructions.
- 6. Apply a spray paint topcoat in the desired color. Apply topcoat evenly on the surround.
- 7. Apply additional topcoats until desired coverage is achieved.

**Appliance Location**

If applicable, according to local electrical codes, the floating mantel is able to conceal a horizontally install wall receptacle behind the bottom mantel section. Refer to Figure 2 to assist in locating the final appliance and mantel location in reference to the receptacle and/or on the wall mounting bracket.

**Note:**

- The top of the floating mantel will be 28 inches (711 mm) from the bottom edge of the wall mounting bracket.
- The mantel bottom will be able to conceal a horizontal wall receptacle if the wall mounting bracket's bottom edge is located in line with the receptacle's standard size faceplate. The outlet (including the standard size faceplate) must be within 28 inches (711 mm) for the SF-TR50 of the desired final appliance centerline.

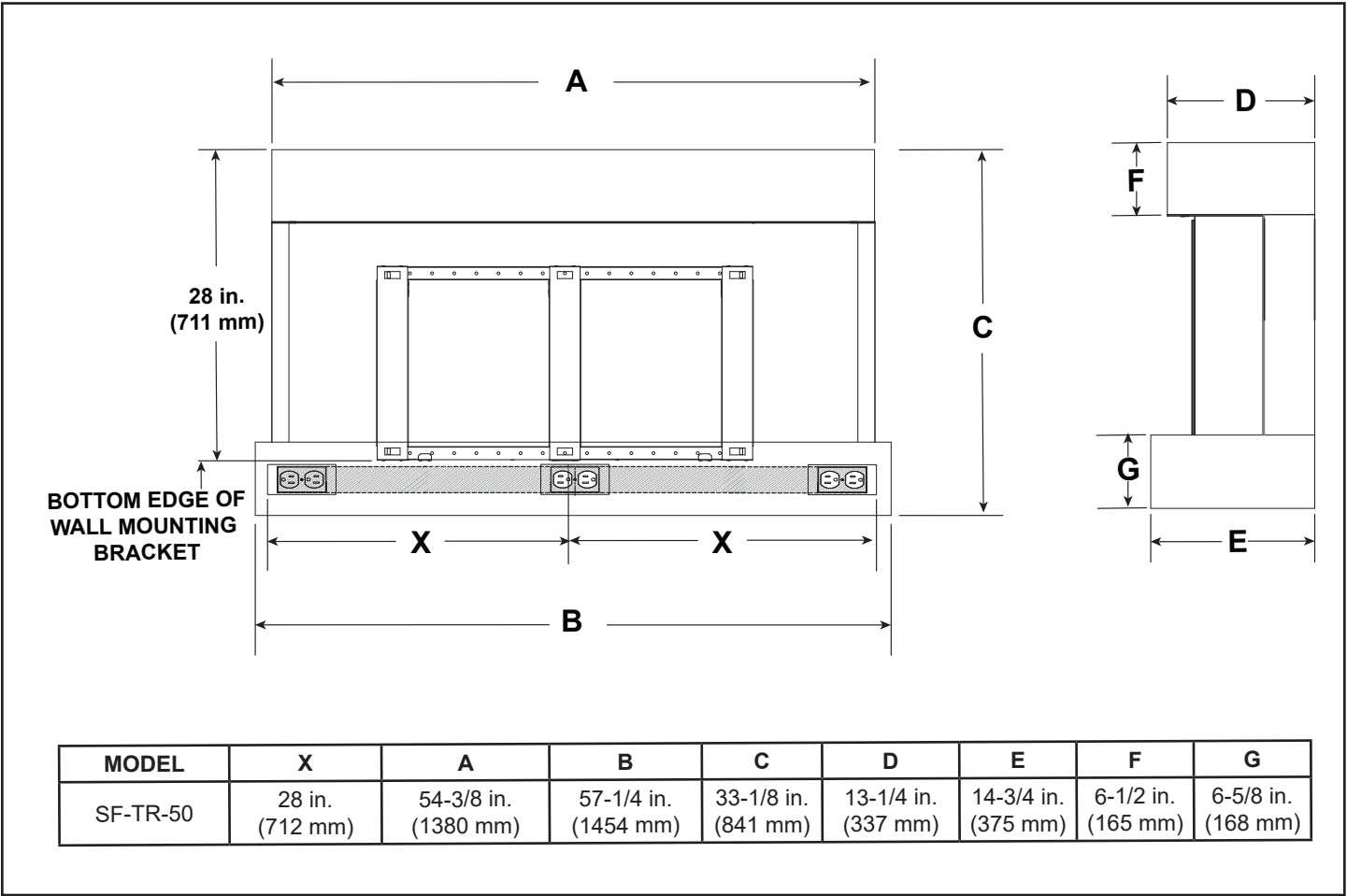

**Figure 2 Mantel Dimensions and Receptacle Location**

## Power Cord Installation

The appliance power cord has a three pin NEMA-5-15P plug. The power cord should not be used unless a grounded receptacle is available.

1. Remove the terminal block cover plate located on the right end of the appliance.
2. Disconnect the terminal block from the three wires inside the appliance. Wires are released by disconnecting the three conductor wire connectors. Discard the terminal block plate.
3. Connect the three conductor wire connectors to the connector on the block supplied with the power cord kit. See Figure 3.
4. Replace cord kit terminal block cover plate and retaining screws. Plug cord into nearest outlet.

**WARNING! Risk of Fire!** Ensure the power cord is not installed so that is pinched or in contact with a sharp edge and ensure that the power cord is stored or secure to avoid tripping and snagging.

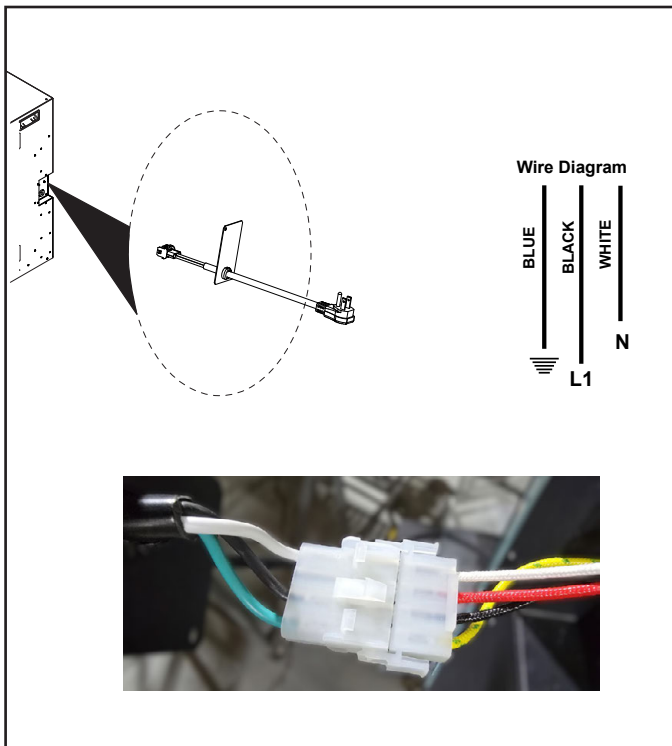

Figure 3 Power Cord Installation

## Direct Wall Mounting with Wall Mounting Bracket

The wall mounting bracket can be installed on masonry walls such as those constructed of brick or concrete, or to framed walls constructed of wood or steel framing sheathed with gypsum wallboard, drywall, wood, etc. The method used to mount the mounting bracket is different between masonry walls and framed walls. Refer to the following sections for more detail on the method applicable to this installation.

### Framed Wall

- Locate the mounting bracket on the wall in the desired location of the appliance. Level the bracket, then mark its location on the wall, including a marking for each of the fastener holes in the bracket.
- For each of the marked mounting point locations, determine which points align with a structural framing member. A minimum of two (2) locations must be secured into a framing member.
- At the points where a wood or metal framing member exists, the ST6X50 screw can be installed directly into that structural member.
- For every mounting hole that does not align with a structural framing member, a wall board toggle-bolt anchor must be used. See Figure 4.

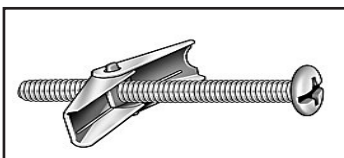

Figure 4 3/16 Toggle-Bolt Anchor

- The toggle-bolt anchors are provided to accommodate the required anchor points based on the appliance. Use of toggle bolt anchors requires drywall thickness of minimum 1/2 in. and drilled holes size of 1/2 in. diameter.
- Insert the bolt through the front side of the mounting bracket and thread the toggle onto it from the rear of the bracket. See Figure 5.
- Fold the toggle wings flush against the bolt and push them through a drilled hole until the toggle wings expand open on the other side. See Figure 6.

Pull back on the bolt and tighten.

**Note:** This product cannot be installed on a wall sheathed with drywall less than 1/2 in. thick, unless all six (6) anchor points in the mounting bracket align with structural framing members.

**NOTICE:** Minimum eight (8) screws and/or toggle bolt anchors are required for wall mounting.

**WARNING! Risk of Damage or Personal Injury!**  
Allowable pull-out and shear strength are 25% of ultimate values or less, as required by building authorities.



Figure 5 Toggle Bolt Installation through Mounting Bracket



Figure 6 Installing Anchors in Hollow Wall

## Masonry Wall

- Locate the mounting bracket on the wall in the desired location of the appliance. Level the bracket, then mark its location on the wall, including a marking for each of the fastener holes in the bracket.

**NOTICE:** Minimum six (6) screws and anchors are required for MASONRY wall mounting.

- In the marked locations, drill 5/16 in. diameter x 2 in. deep holes. See Figure 7.
- Insert the provided wall anchors into the holes.
- Gently tap the anchors with a hammer until they are flush with the wall surface.
- With mounting hooks pointed up, attach the bracket to the masonry anchors with ST6X50 screws. See Figure 8.

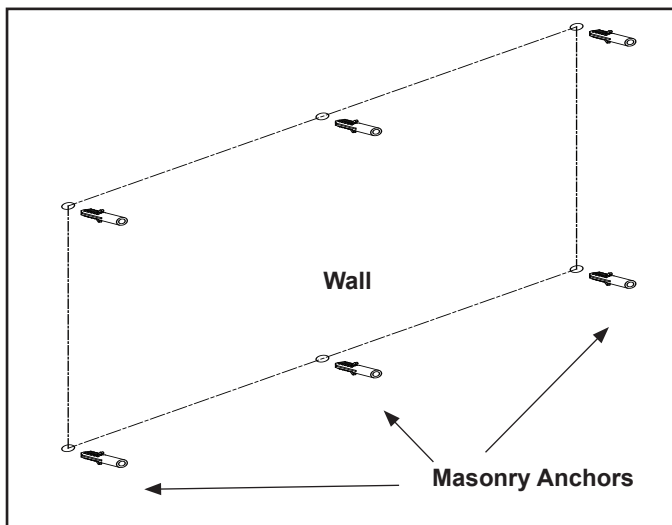

Figure 7 Masonry Anchor Placement

**WARNING! Risk of Damage or Personal Injury!** Do not use supplied masonry anchors on hollow walls, sheathed with wood, gypsum wallboard, drywall or other materials.

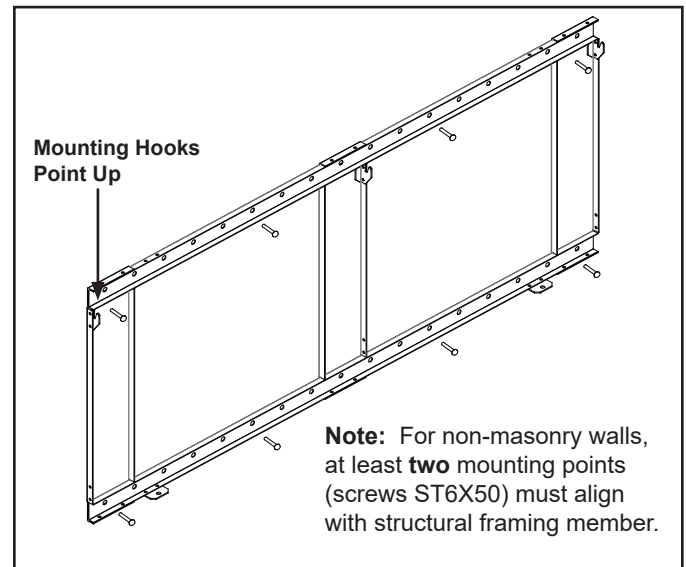

Figure 8 Bracket Attachment



## Stabilizing Bracket Installation

**Note:** The stabilizing bracket is used to stabilize and level the appliance against the wall. It does not support the weight of the appliance or assist in locating the appliance flush to the wall.

1. Remove the two outer screws from the top of the appliance. See Figure 9.
2. Place stabilizing bracket so the two outer holes on the bracket align with the outer holes on the appliance.
3. Attach the stabilizing bracket to the top of the appliance using three (3) ST4x12 screws. See Figure 10.



Figure 9 Remove Outer Screws

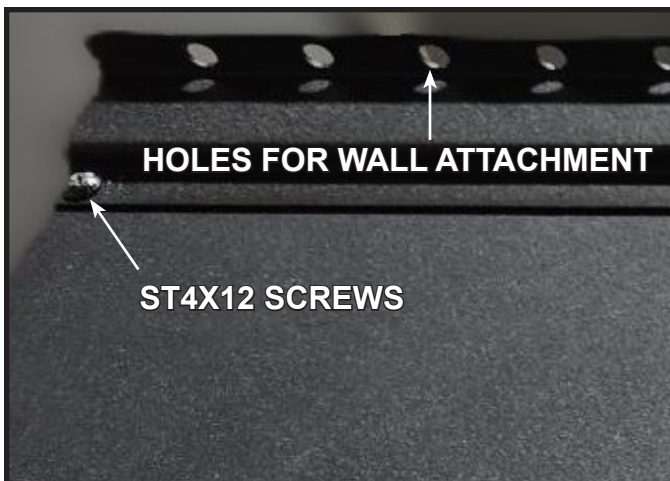

Figure 10 Attach Stabilizing Bracket

## Appliance Installation

1. Hang appliance on the mounting bracket.
2. Align the slots on the back of the appliance with the hooks on the top two corners of the bracket.
3. Hang the appliance and pull down to ensure the hooks are fully engaged. See Figure 11.
4. Secure the appliance to the bracket with two M5X10 screws. See Figure 11.
5. Secure the stabilizing bracket using 6 x 50 screws to attach to three (3) wall studs through the holes noted in Figure 10.

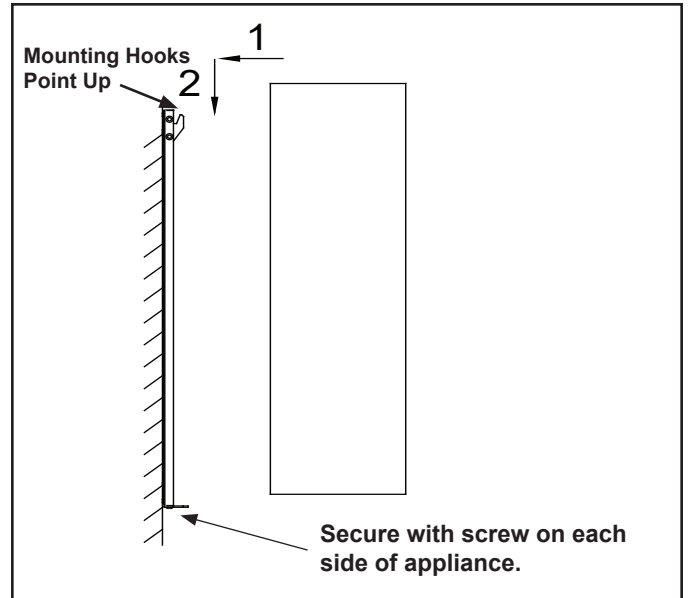

Figure 11 Attach Appliance to Bracket

## Mantel Installation

1. Remove flat side cover-plates by removing seven (7) screws on each side. See Figure 12.

Re-use the screws removed from the cover-plates to install and align the 2-inch (51mm) top mounting trim pieces, provided with the mantel kit, on right and left side of the appliance. See Figure 12. Continue by installing the rear and bottom 2-inch (51mm) trim pieces provided with the appliance.

**Note:** The top 2-inch trim has two extra holes for attaching the top mantel, as shown in Figure 12.

**Note:** The back side trim bracket is optional to use depending on the preferred finish. If you want a clean black finish to match the rest of the trim use this piece. If you'd prefer the white finish of the mantel remove this piece.

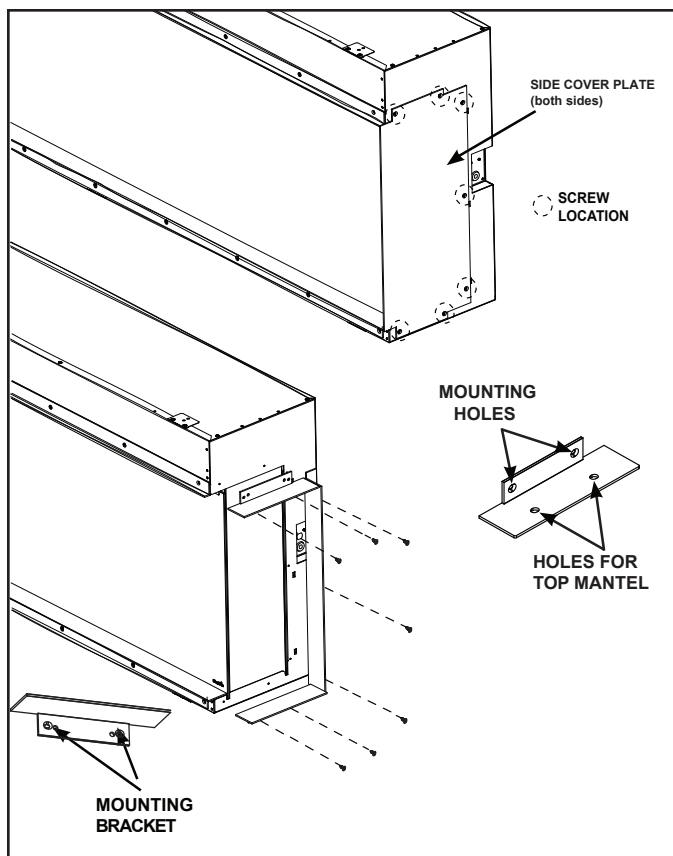

Figure 12

2. Attach the two bottom brackets, one (1) on each side to both sides of the appliance using four (4) ST4\*12 screws. See Figure 13.

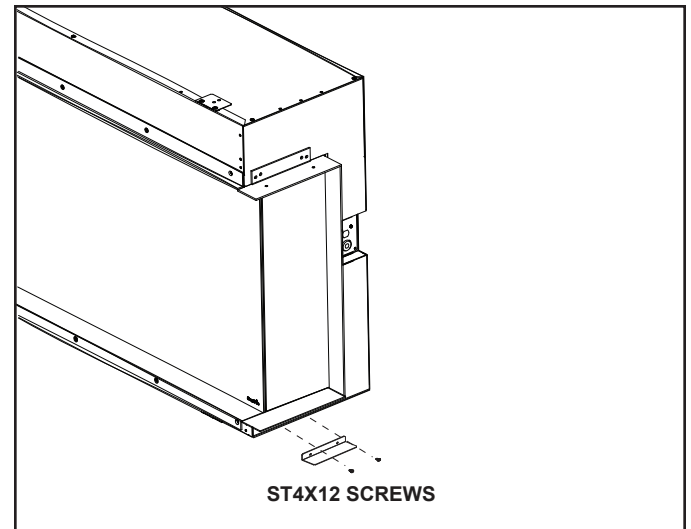

Figure 13

3. Attach the front bracket to the appliance using two (2) ST4\*12 screws. See Figure 14.

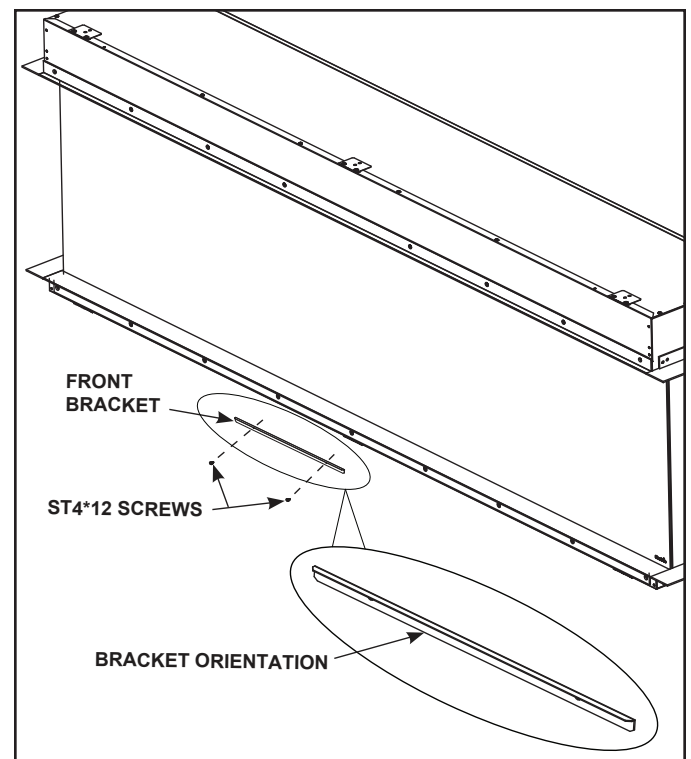

Figure 14

4. Position the bottom mantel between the bottom two-inch (51 mm) trim and the bottom brackets and slide into place. See Figure 15.

**Note:** The mantel bottom has an opening for the power cord to drop through. This opening will signify which is the bottom piece.

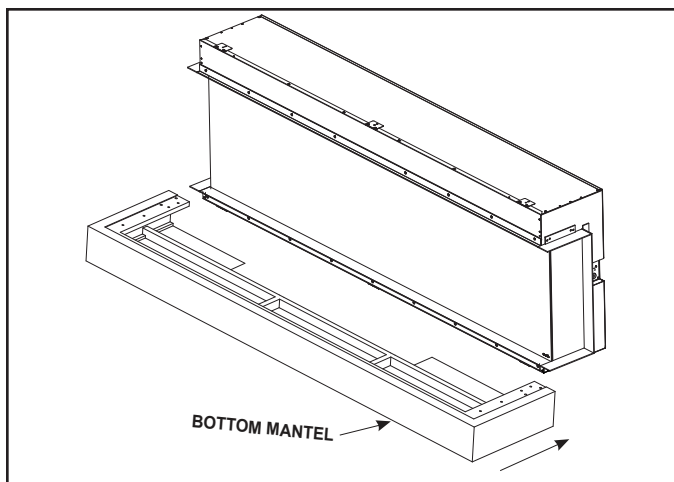

Figure 15

5. Attach two (2) side brackets to the rear sides of the appliance using four (4) ST4\*12 screws. See Figure 16.

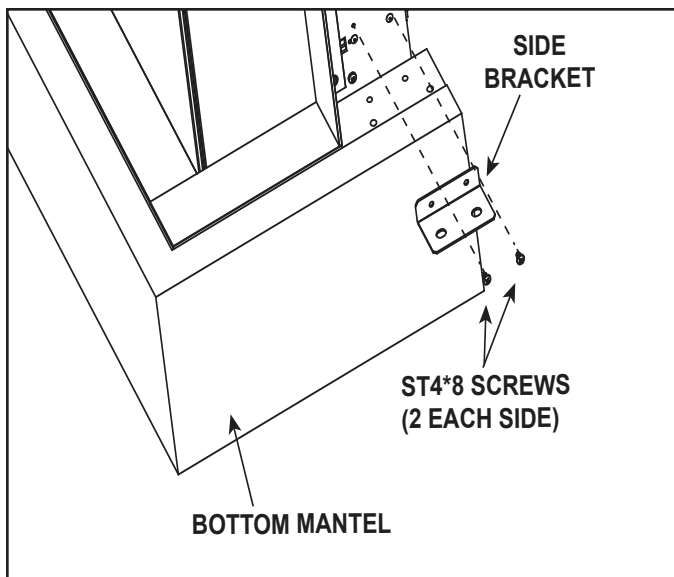

Figure 16

6. Secure the bottom mantel to the side brackets using four (4) M6\*16 screws. See Figure 17.

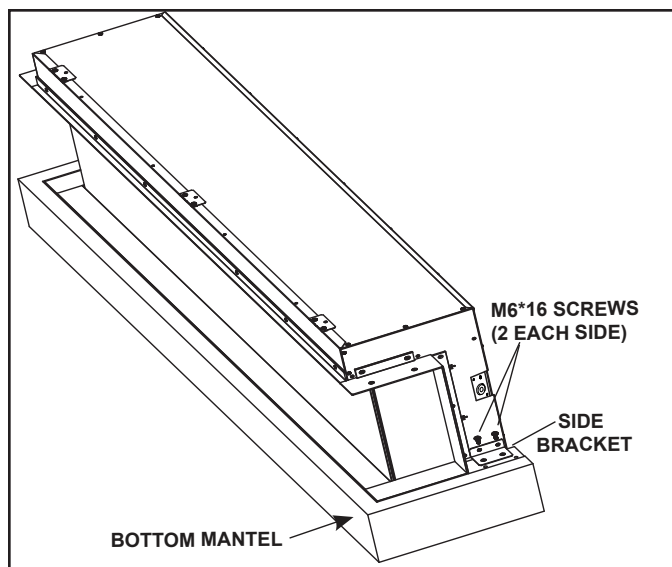

Figure 17

7. Insert the four (4) wooden dowels into the open holes of the bottom mantel. See Figure 18.

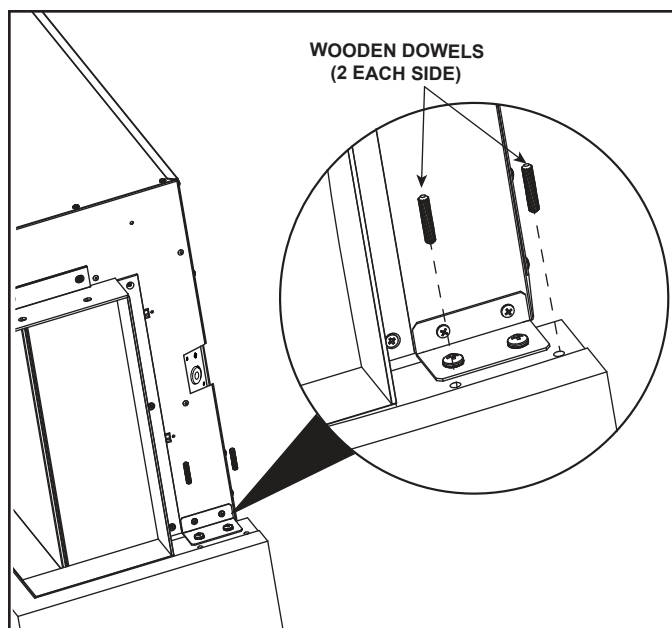

Figure 18



8. Attach the mantel side panels to the bottom mantel by aligning the holes in the mantel sides with the dowels. See Figure 19.

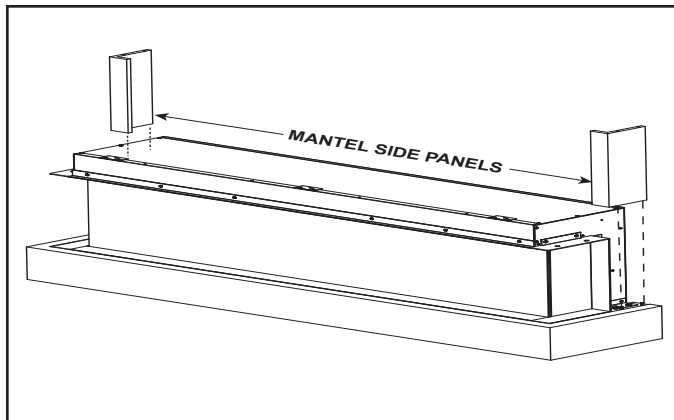

Figure 19

9. Insert the two (2) wooden dowels on each side into the open holes in the top of the mantel side panels. See Figure 20.

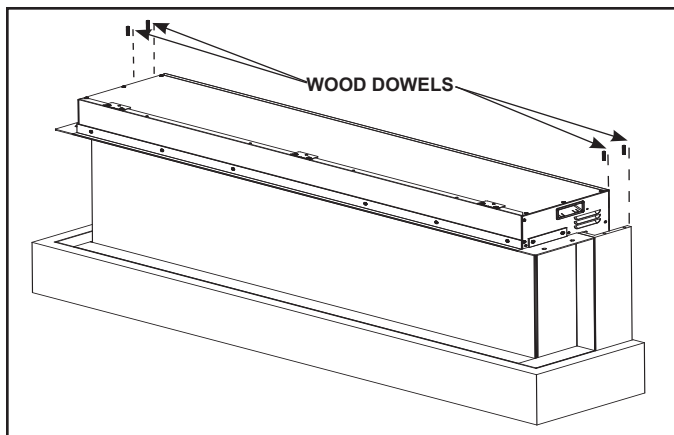

Figure 20

10. Attach the mantel top to the mantel side panels by aligning the holes in the mantel top with the dowels. See Figure 21.

**Note:** The mantel top will not have an opening and will be flush to the wall.

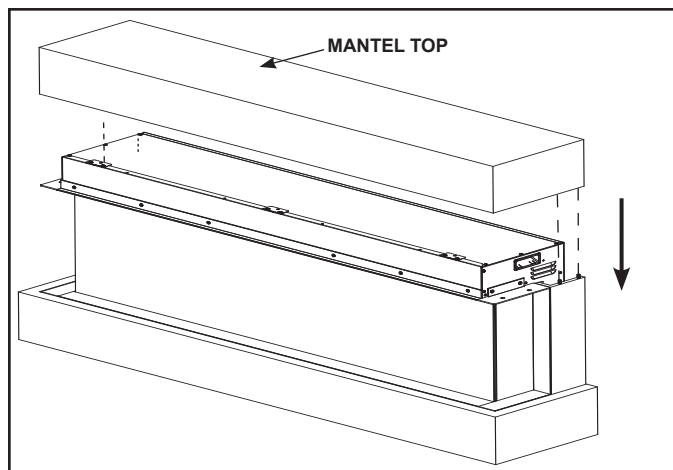

Figure 21

11. Secure the top mantel to the side brackets using two (2) M6\*16 screws on each side. See Figure 22.

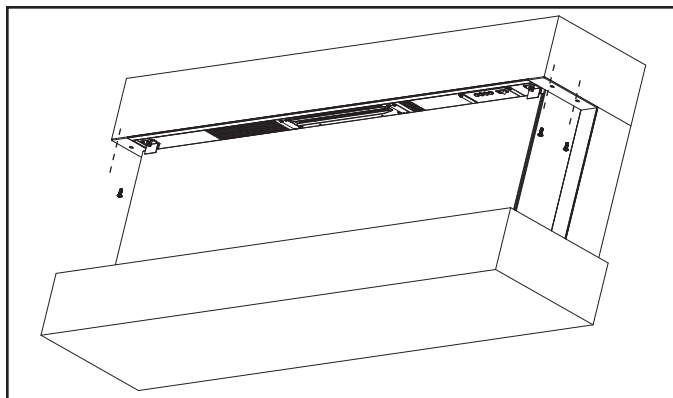

Figure 22

The total weight of objects sitting on the mantel shelf must not exceed 100 lbs (45 Kg).

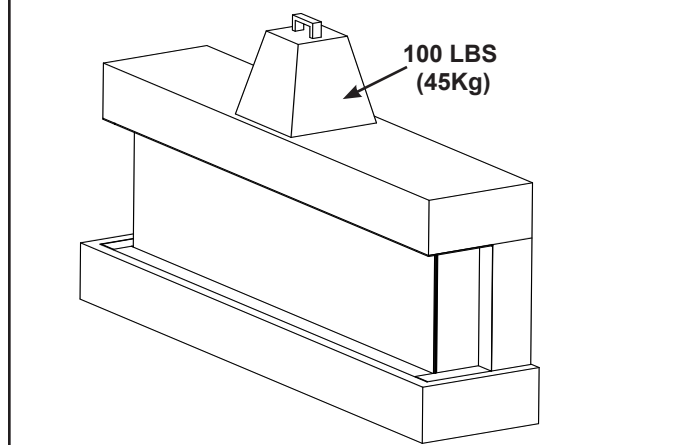

Figure 23 Wall Mount Weight Capacity